

PILLAR CAPS SHEET 1 - LAST REVISION 1/2/07

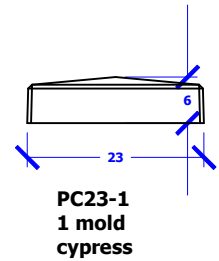

882 N. Marshall Way
Layton, UT 84041
Ph. (801) 544-9054
Fax: (801) 544-9154

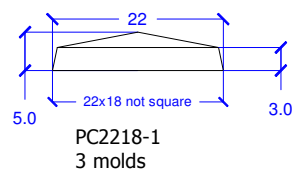
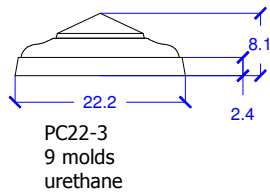
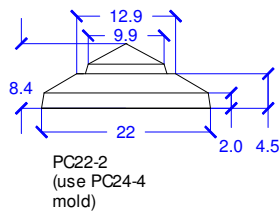
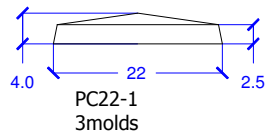
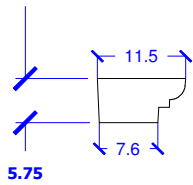
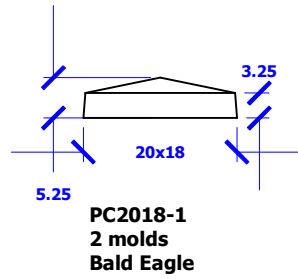
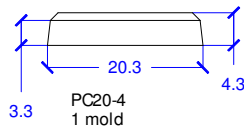
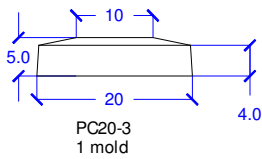
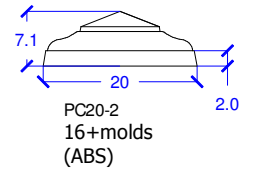
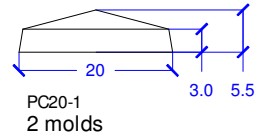
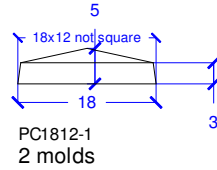
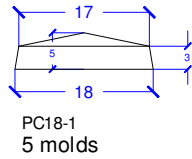
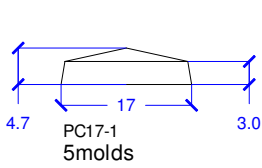
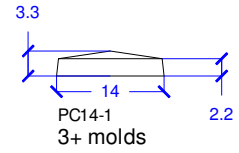
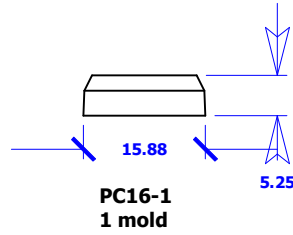
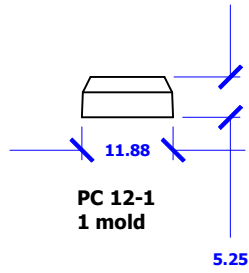
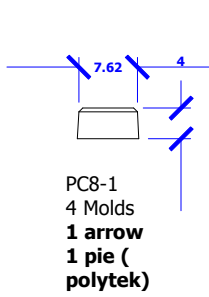

PILLAR CAPS SHEET 2 - LAST REVISION 1/2/07



882 N. Marshall Way
 Layton, UT 84041
 Ph. (801) 544-9054
 Fax: (801) 544-9154

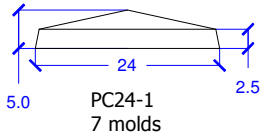

PC24-1
7 molds

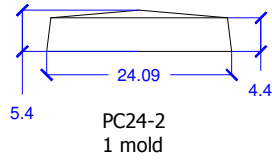

PC24-2
1 mold

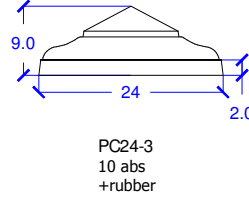

PC24-3
10 abs
+rubber

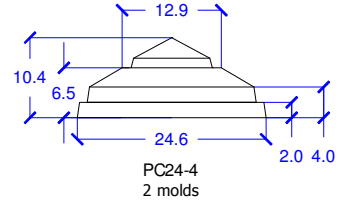

PC24-4
2 molds

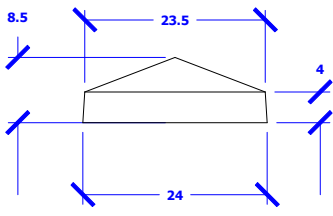

PC24-5 1 mold compatible
with S7-2

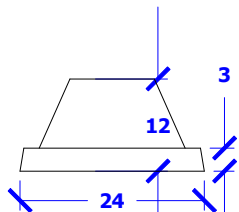

PC24-6 One Mold

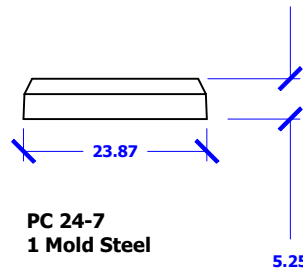

PC 24-7
1 Mold Steel

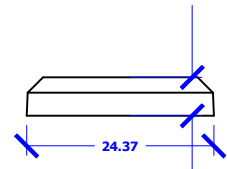

PC24-8
3 molds
3 dividers
hole forms
Ivory Swim

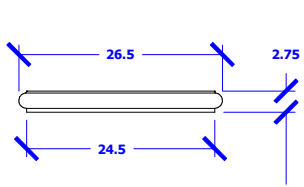

PC2517-1 Bullnose
2 molds
not square

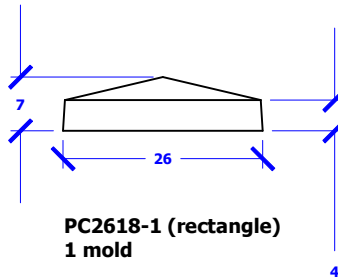

PC2618-1 (rectangle)
1 mold

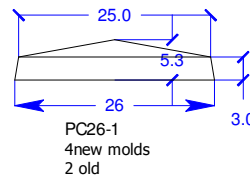

PC26-1
4 new molds
2 old

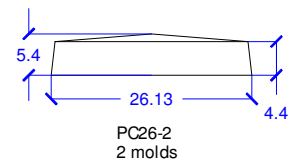

PC26-2
2 molds

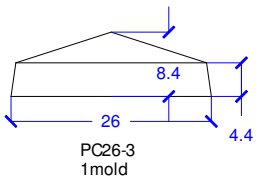

PC26-3
1 mold

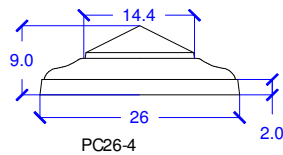

PC26-4

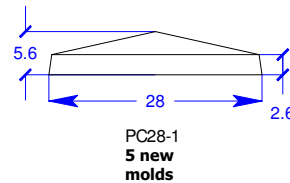

PC28-1
5 new
molds

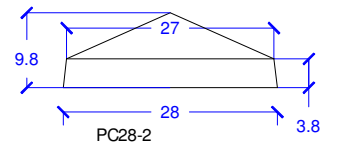

PC28-2

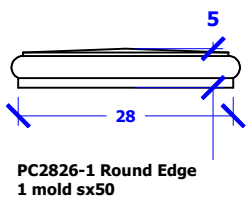

PC2826-1 Round Edge
1 mold sx50

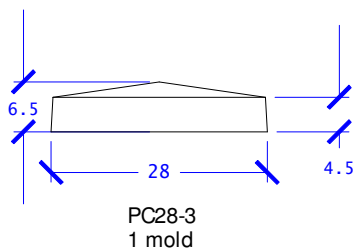

PC28-3
1 mold

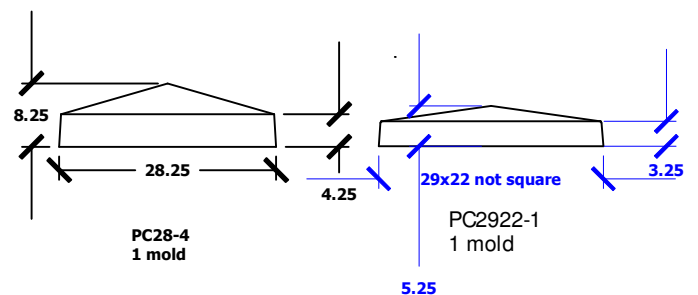

PC28-4
1 mold

PC2922-1
1 mold

5.25

PILLAR CAPS SHEET 3 - LAST REVISION 1/2/07



882 N. Marshall Way
Layton, UT 84041
Ph. (801) 544-9054
Fax: (801) 544-9154

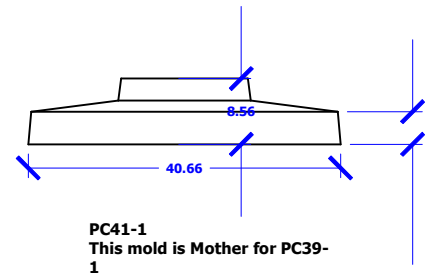
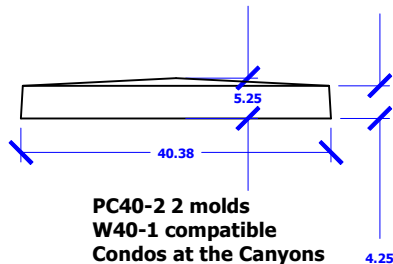
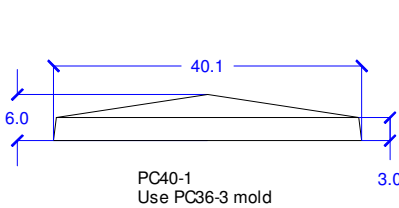
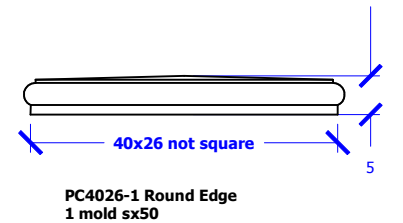
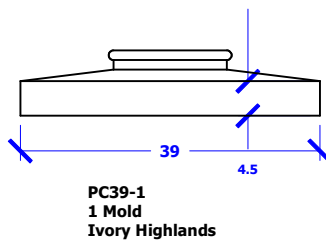
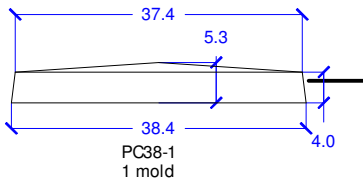
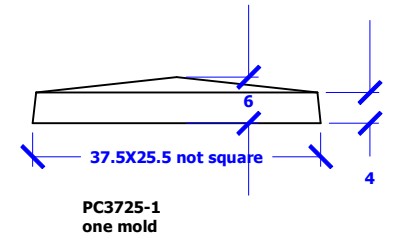
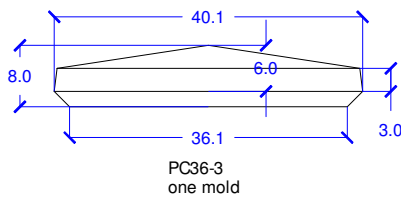
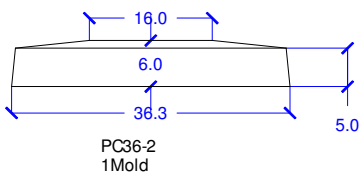
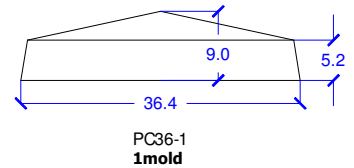
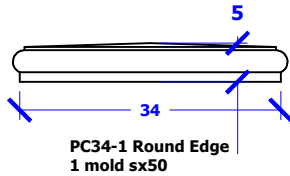
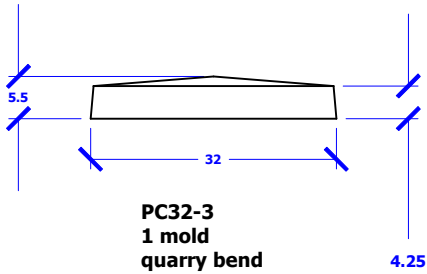
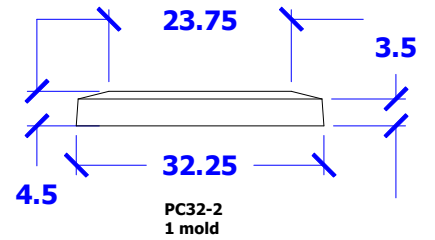
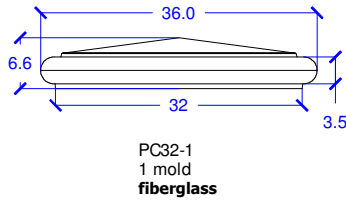
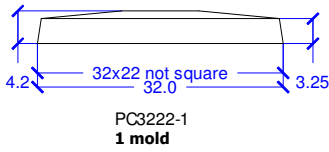
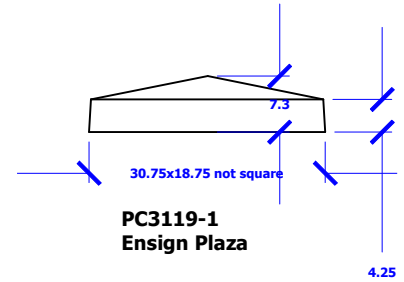
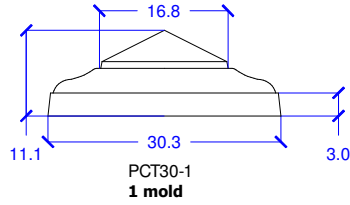
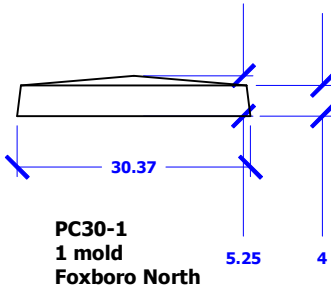

PILLAR CAPS SHEET 4 - LAST REVISION 1/2/07



882 N. Marshall Way
Layton, UT 84041
Ph. (801) 544-9054
Fax: (801) 544-9154

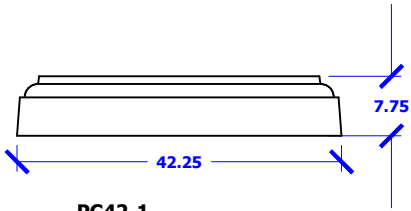

PC42-1
1 mold
Ivory Highlands

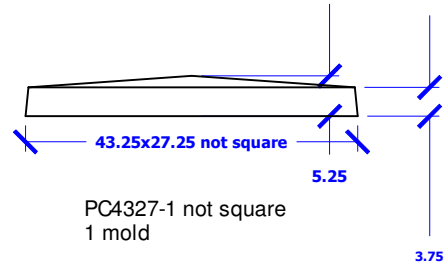

PC4327-1 not square
1 mold

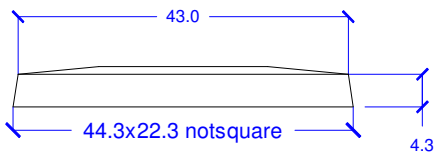

PC4422-1
1 mold

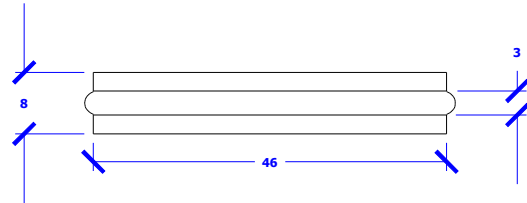

PC46 Bull Edge
Adjustable to 46x46

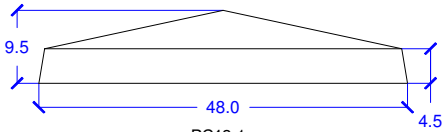

PC48-1
1 mold

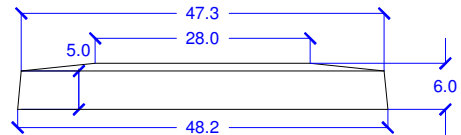

PC48-2
1 mold

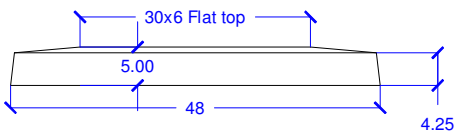

PC4824-1 not Square
1 mold

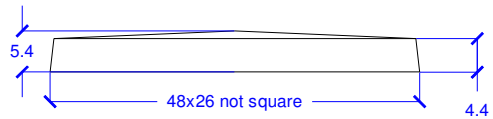

PC4826-1
1 mold

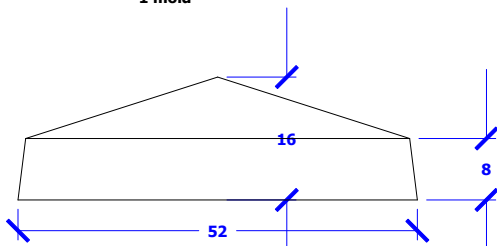

PC52-1
1 mold

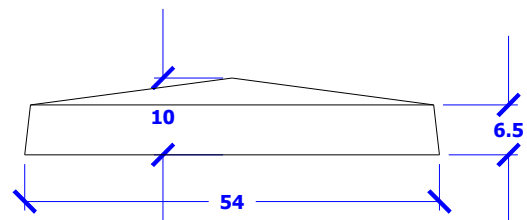

PC54-1
1Mold

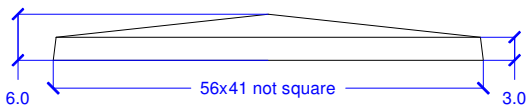

PC5641-1
1 mold

PILLAR CAPS SHEET 5 - LAST REVISION 7/18/07



882 N. Marshall Way
Layton, UT 84041
Ph. (801) 544-9054
Fax: (801) 544-9154

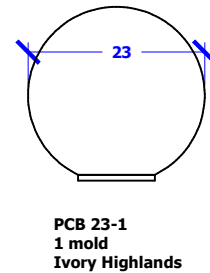
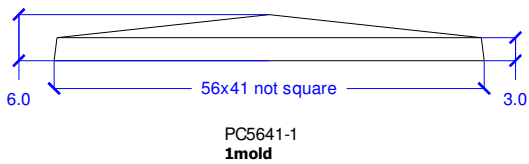
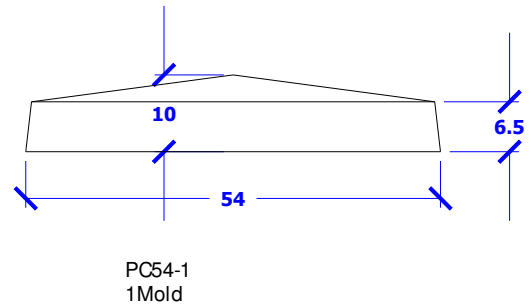
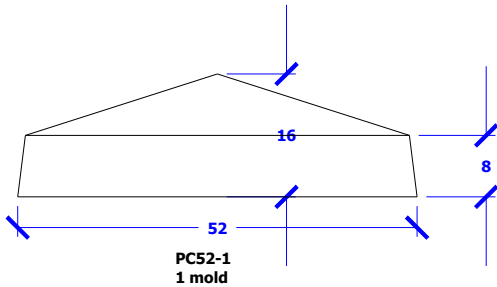
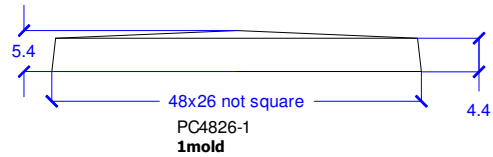
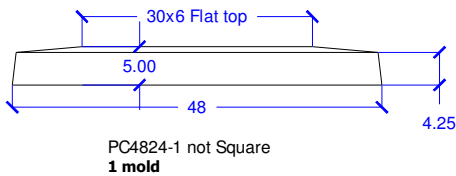
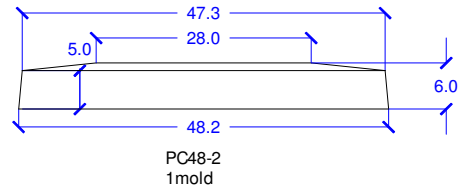
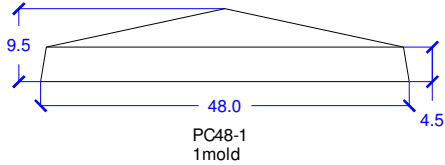

PILLAR CAPS SHEET 6 - LAST REVISION 7/18/07



882 N. Marshall Way
Layton, UT 84041
Ph. (801) 544-9054
Fax: (801) 544-9154

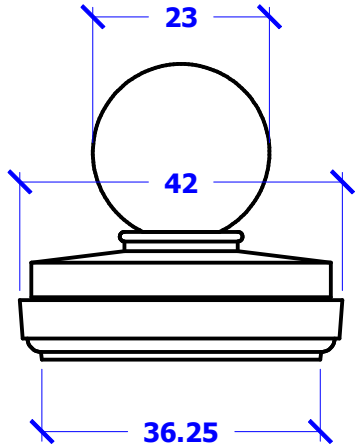

Example:
PCB23-1 Top Ball
PC39-1 Full Thick Base Under Ball
PC42-1 Full Thick Lower Base
These Molds used for Ivory Highlands in Taylorsville